



GAMAR ITALIA

QLS

QUICK LACING SYSTEM

ASSEMBLY INSTRUCTIONS



GAMAR ITALIA

QUICK
LACING
SYSTEM

QLS

MADE IN ITALY

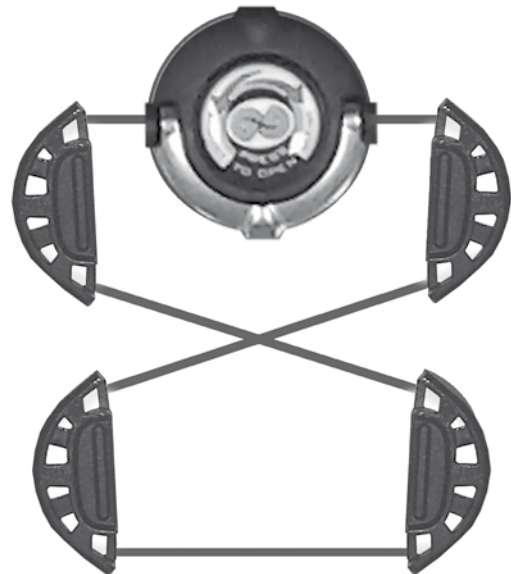
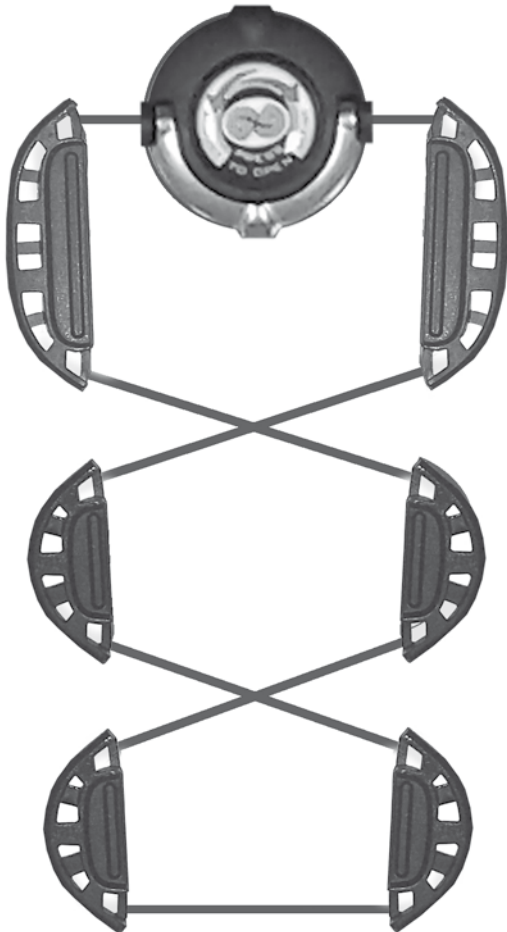



GAMAR ITALIA

QUICK
LACING
SYSTEM

QLS

MADE IN ITALY

PUT THE BASE UNDER THE TONGUE
OF THE SHOE.

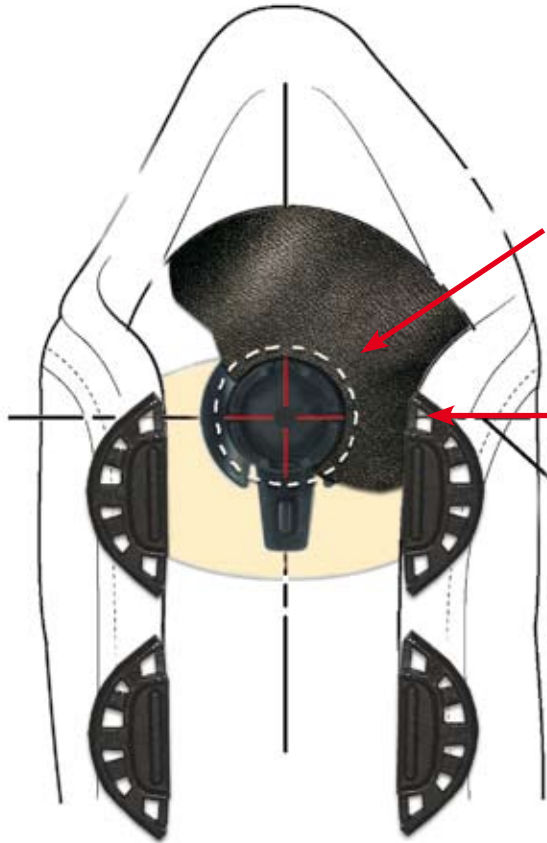

YOU NEED TO STITCH
ALL AROUND ONLY ONCE.

ALIGN EACH CAVITY OF THE BASE TO
THE UPPER PART OF THE LACE LOOP
TO ENABLE THE WIRE TO COME OUT
FROM THE BASE HORIZONTALLY.

DO NOT USE SOLVENT GLUE.



TO INSERT THE REEL JUST
PRESS WITH YOUR HAND.
(SEE PAGE 8)



GAMAR ITALIA

QUICK
LACING
SYSTEM

QLS

MADE IN ITALY

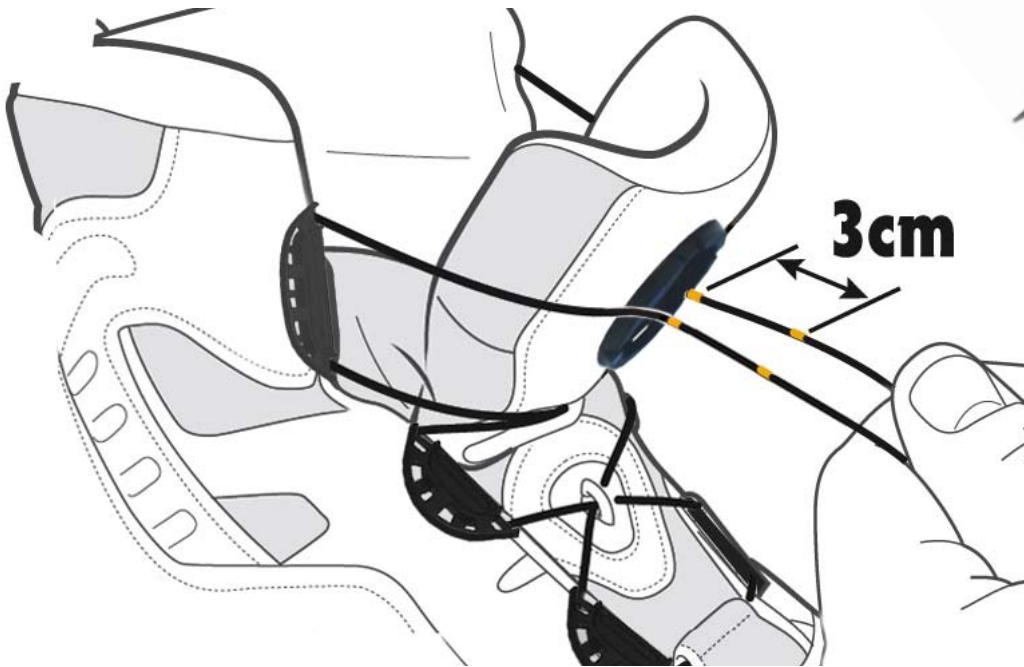

SPECIAL SCISSORS,
EXAMPLE :
“D-SPLICER” TO BE
ABLE TO CONTROL
THE CUT OF THE
DYNEEMA OR ARAMID
WIRE.

CUT THE WIRE IN THE RIGHT SIZE TO PERMIT THE COMPLETE OPENING OF THE SHOE PLUS 3CM AT EACH EDGE.

THE KNOTS AT EACH EDGE OF THE WIRE GUARANTEE THE LOCKING ON THE REEL, INSERT THEM IN THE PROPER COMPARTMENTS ON ITS BACK.
(SEE PAGES 5-6-7)



ATTENTION:
BEFORE INSERTING THE WIRE KNOTS, BE SURE THAT THE TWO CAVITIES, BOTH THE ONE IN THE EXTERNAL CIRCUMFERENCE AND THE ONE IN INSIDE THE REEL, ARE ALIGNED THE ONES WITH THE OTHERS.
(SEE PAGE 8)





GAMAR ITALIA

QUICK
LACING
SYSTEM

QLS

MADE IN ITALY

EXPLICATION HOW TO KNOT PROPERLY
THE WIRE.

DEMONSTRATION FOR THE KNOT FOR :
_ POLYPROPYLENE AND ARAMID WIRES
_ NYLON COATED STEEL WIRES

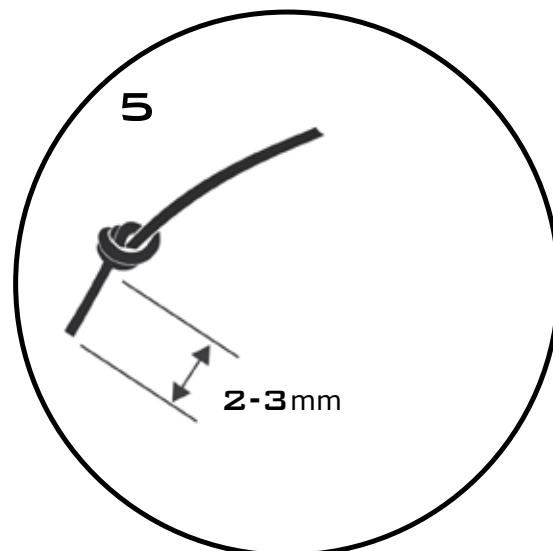
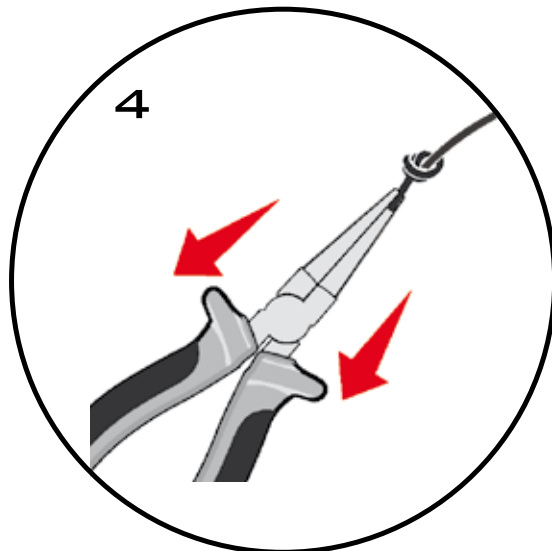
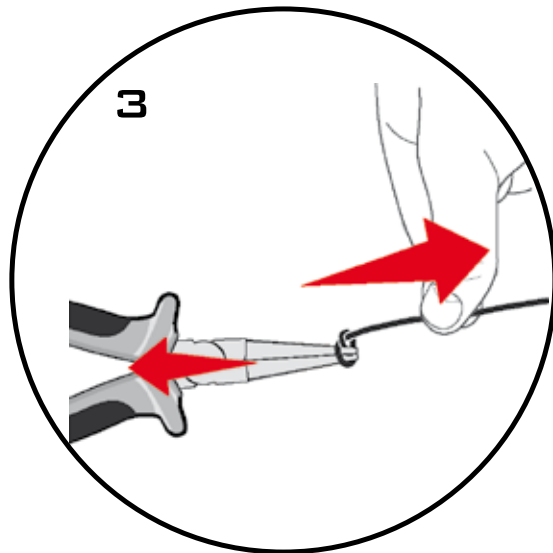
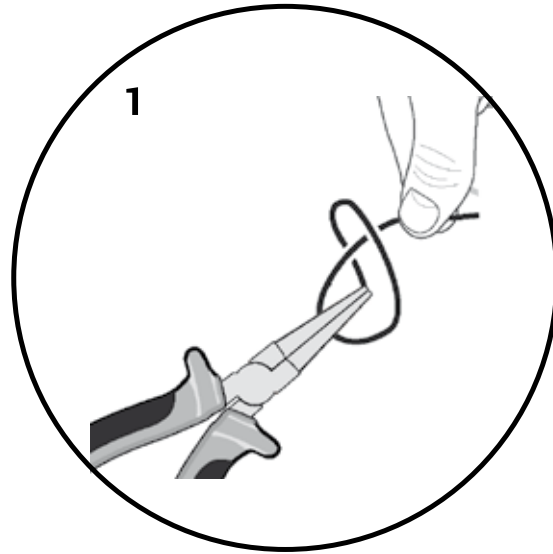
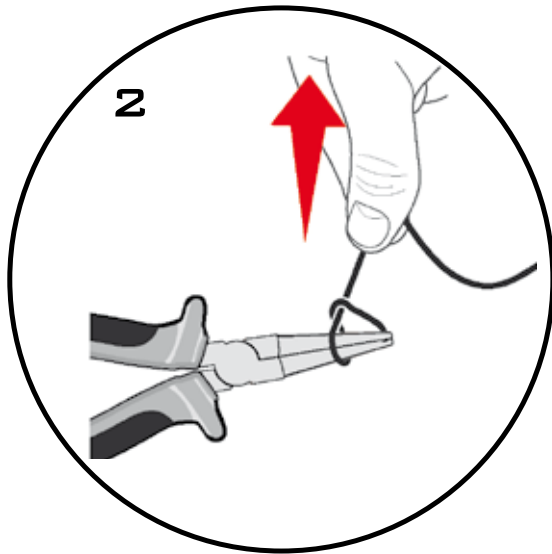



GAMAR ITALIA

QUICK
LACING
SYSTEM

QLS

MADE IN ITALY

DEMONSTRATION FOR THE KNOT FOR :
_DYNEEMA WIRES

ATTENTION:
DOUBLE THE WIRE TO GET
A KNOT THICK ENOUGH.

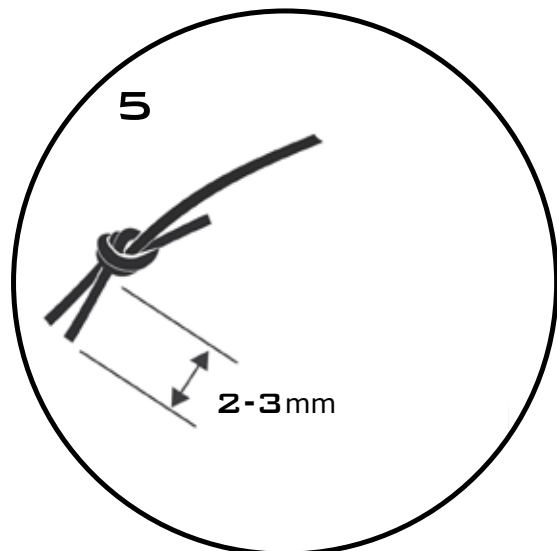
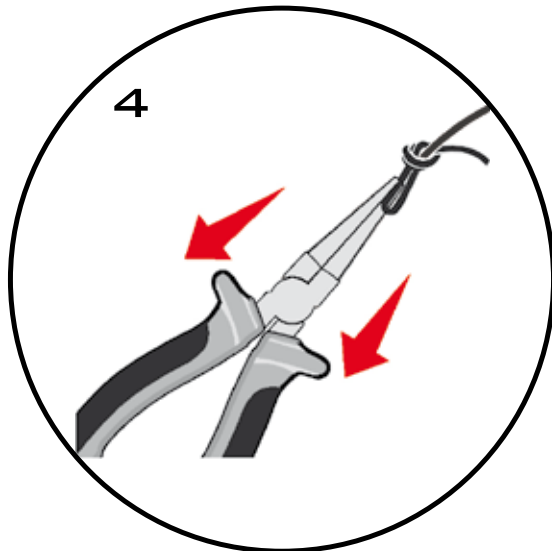
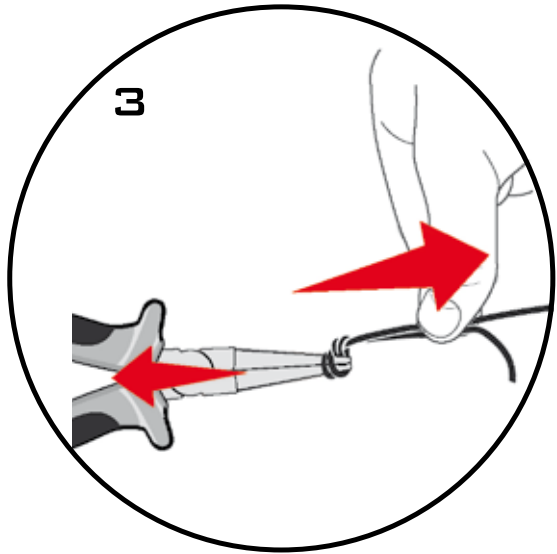
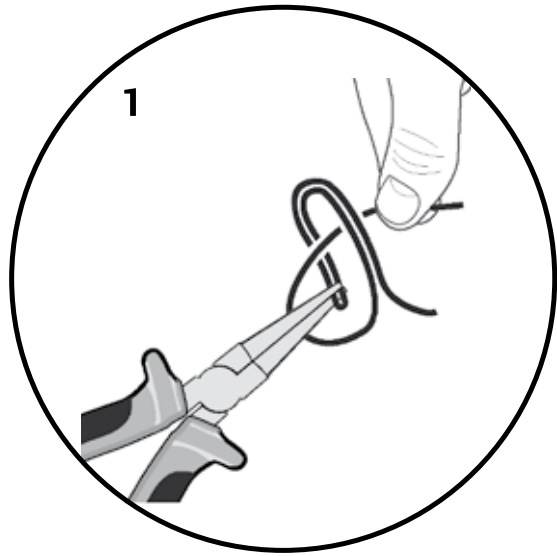
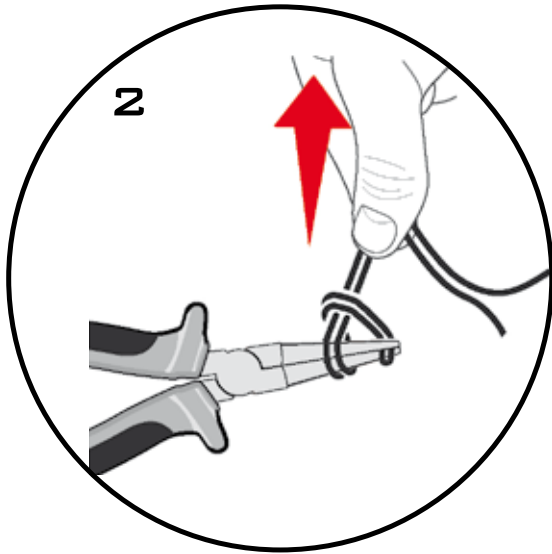



GAMAR ITALIA

QUICK
LACING
SYSTEM

QLS

MADE IN ITALY

IT IS POSSIBLE TO USE 49 STRAND NYLON COATED STAINLESS STEEL WIRES,
DIAMETER 0.8MM, LENGTH 750MM - 1050MM - 1350MM.
(DIFFERENT LENGTHS ARE AVAILABLE UPON REQUEST).

STAINLESS STEEL WIRES ARE ALREADY PREPARED WITH TERMINAL CLAMPS TO
LOCK INTO THE REEL.



TERMINAL IN ZINC
ALLOY INJECTED.





GAMAR ITALIA

QUICK
LACING
SYSTEM

QLS

MADE IN ITALY

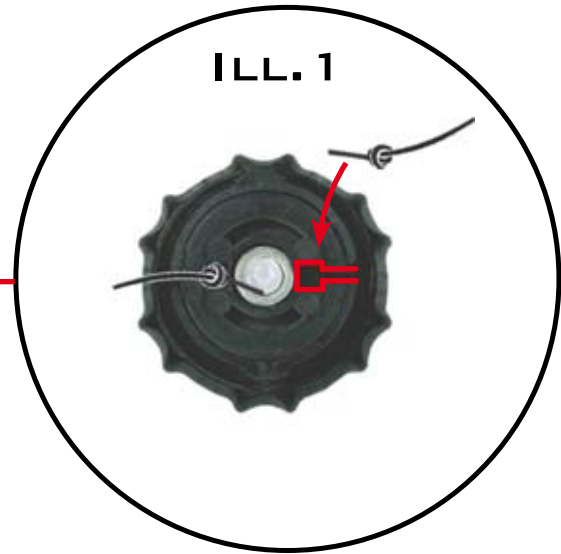
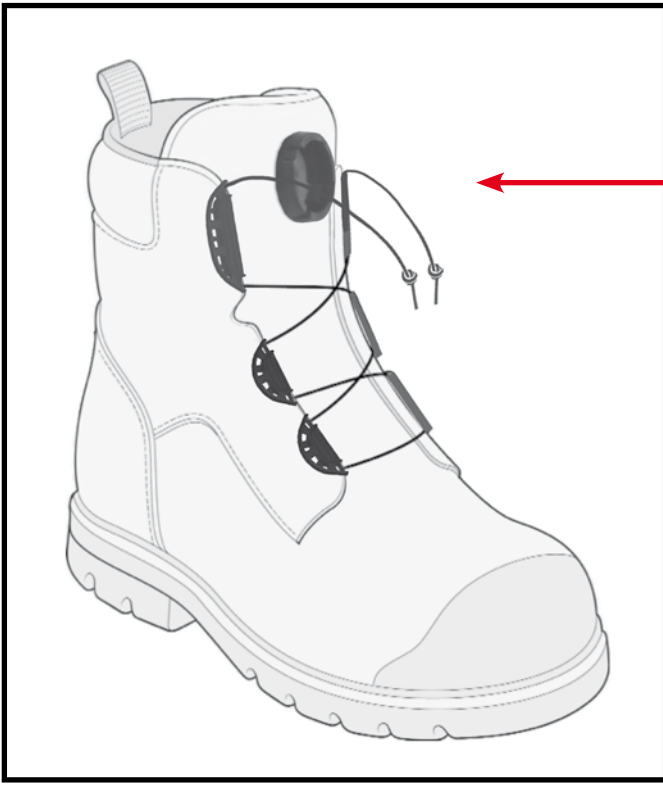

ILL. 1 WIRES ARE INSERTED IN THEIR OWN COMPARTMENTS MANUALLY.

ILL. 2 MANUAL LOCKING OF THE REEL INTO ITS OWN BASE BY PRESSURE RELEASE.





GAMAR ITALIA

QUICK
LACING
SYSTEM

QLS

MADE IN ITALY

THREE ACTION REEL

1: CLOCKWISE ROTATION TO TIGHTEN THE WIRE.



2: COUNTERCLOCKWISE ROTATION PERMIT MICRO-ADJUSTABILITY FOR THE COMFORT OF THE SHOE.

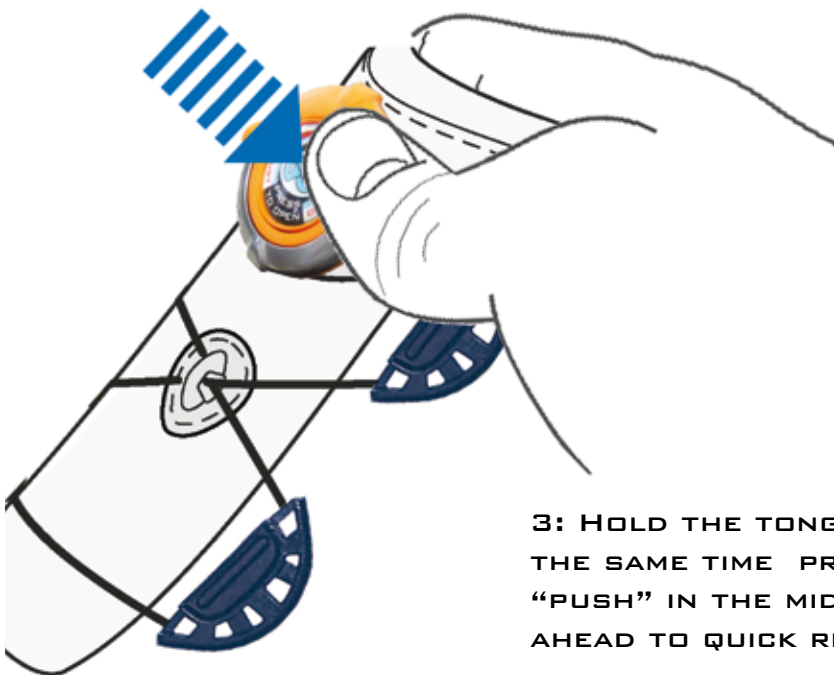

3: HOLD THE TONGUE AND IN THE SAME TIME PRESS THE "PUSH" IN THE MIDDLE PULLING AHEAD TO QUICK RELEASE.



GAMAR ITALIA

QUICK
LACING
SYSTEM

QLS

MADE IN ITALY

ATTENTION



WE SUGGEST NOT TO EXCEED
70°C/80°C WHEN THE SHOE GOES
INSIDE THE STABILIZATION OVEN.



IT IS POSSIBLE TO PERSONALIZE THE LABEL WITH COMPANY 'S OWN LOGO

- ✓ HIGHLY ADHESIVE 3M MATERIAL.
- ✓ TEMPERATURE RESISTANCE : -40°C TO 150°C (NO CHANGES).
- ✓ HUMIDITY RESISTANCE : 168 HOURS AT 38°C AND 100% RELATIVE HUMIDITY (NO CHANGES)
- ✓ WATER RESISTANCE : 48 HOURS IMMERSION AT 22°C (NO CHANGES)



GAMAR ITALIA

QUICK
LACING
SYSTEM

QLS

MADE IN ITALY

LATERAL SYSTEM LEFT-RIGHT



REELS SYSTEM FOR LATERAL ASSEMBLING. TO TIGHTEN THE WIRE YOU HAVE TO TURN CLOCKWISE BOTH LEFT AND RIGHT REELS, TO LOOSEN THE WIRE AND OPEN THE SHOES YOU HAVE TO TURN COUNTERCLOCKWISE BOTH REELS. STITCH THE HALF CIRCLE PART OF THE BASE UNDER THE UPPER. THE REST OF THE BASE WILL BE FREE FROM THE LEATHER SO THAT IT WILL BE POSSIBLE TO SCREW OR UNSCREW THE REEL ON THE BASE..

EXAMPLE OF MODEL WITH QLS LATERAL SYSTEM.



ASSEMBLING OF THE REEL

PICT.1: STITCH THE BASE ON THE UPPER. INSERT THE WIRE THROUGH THE LATERAL LACE LOOPS, THEN PUT THE WIRE INTO THE TWO HOLES ON THE BASE. MAKE THE KNOTS AT THE TWO EDGES OF THE WIRE AS SHOWN IN PICT. 1-3.

PICT.2: INSERT THE KNOTS INTO THE PROPER COMPARTMENTS ON THE REEL. LOCK THE REEL INTO ITS BASE WITH THE WIRE TIGHTENED OUTSIDE. FIX THE REEL WITH THE PROPER SCREW, BUT TAKE CARE TO SCREW ONLY UNTIL COMPLETE CLOSURE OF THE SYSTEM WITHOUT FORCING TOO MUCH, TO AVOID ANY BREAKAGE, STRIPPING OR BLOCK OF THE SYSTEM.

PICT.3: THE PICTURE SHOWS HOW TO KNOT THE WIRE EDGES TOGETHER. THE RED AND THE BLUE WIRES STAND FOR THE TWO WIRE EDGES PICTURE 3A. TIGHTEN THE KNOTS AS MUCH AS POSSIBLE (BY MEANS OF TWO PLIERS) PICTURE 3B. PULL THE LEFT AND THE RIGHT PART OF THE WIRE TO THE OPPOSITE DIRECTIONS TO JOIN THE TWO KNOTS TOGETHER PICTURE 3C.

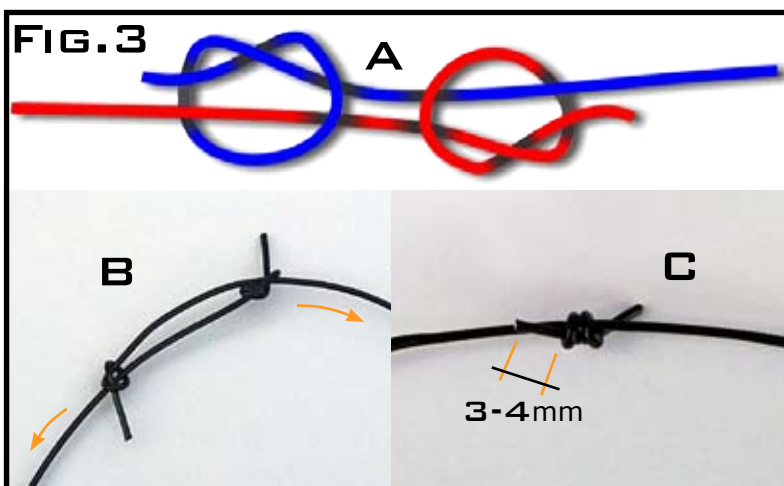



GAMAR ITALIA

QUICK
LACING
SYSTEM

QLS

MADE IN ITALY

LATERAL SYSTEM LEFT-RIGHT

BASE STITCHING

